



STAINLESS STEEL

Lpg gas countertop fryer



MATERIAL:

- 20GA.430S/S construction
- 20GA.430S/S tube style tank;430S/S with nickel plating basket
- 20GA.430S/S lid
- Cast aluminum burners



MECHANICAL:

- 16,036 BTU per burner
- Baskets gas deep fryer, with temperature control
- With heat insulation cotton on left&right side
- With non-slip feet
- Electronic ignition
- 3/4" rear gas connection
- Capacity: 6L/tank
- Available for lpg gas
- Wooden crate and carton box packing

DIMENSIONS and SPECIFICATIONS

MODEL	SIZE	G.W.
17mcbn-71	11 2/5"X19 1/2"X18 1/2"	20 lbs.
17mcbn-72	22 11/25"X19 1/2"X18 1/2"	35 lbs.

SPEC DRAWING:

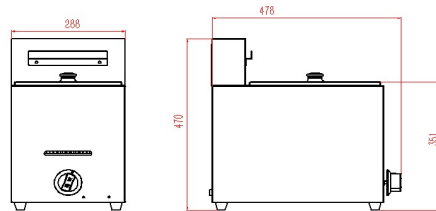

Model:17mcbn-71

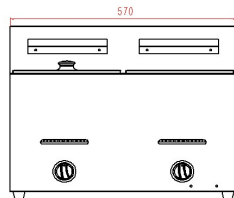
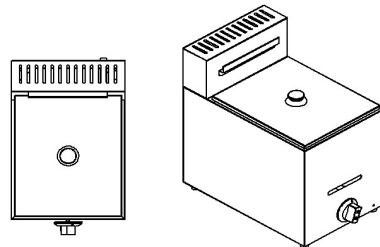

Model:17mcbn-72

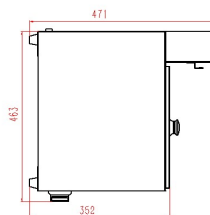
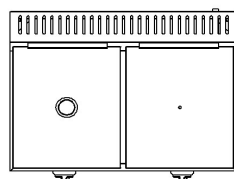

Distributed by masterchefpr.com

Tel: 787 788-2264 / 787 788-2269 / 787 275-1643