

Beer Box



MATERIAL:

- 18GA.304S/S bowl, top, bottom and backsplah
- 16GA.304S/S perforated false bottom
- 18GA.304S/S apron
- 16GA.304S/S divider 20"X5"X16"H
- 18GA.304S/S hinged cover 22"X47"X1"
- Galvanized leg and socket, plastic bullet feet

CONSTRUCTION:

- Beer box 24"X48"X30"H with 3" backsplash
- 20-3/4"X45-3/4"X18" bowl

MECHANICAL:

- S/S divider is optional
- S/S hinged cover with padlock and two keys are optional
- "U" shape leg bracing



S/S divider



S/S hinged cover

DIMENSIONS and SPECIFICATIONS

MODEL	SIZE	G.W.
17cenbb244818	24"X48"X30"	250 lbs

SPEC DRAWING:

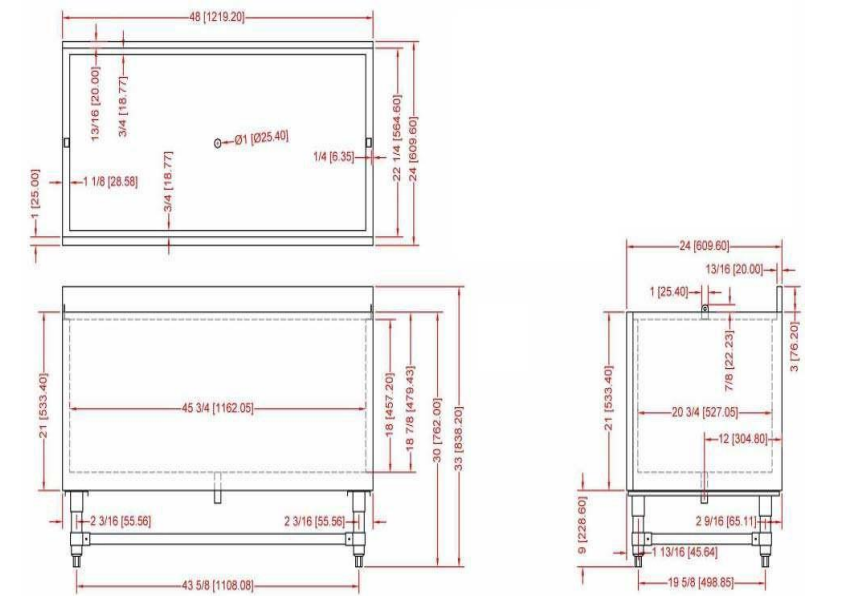

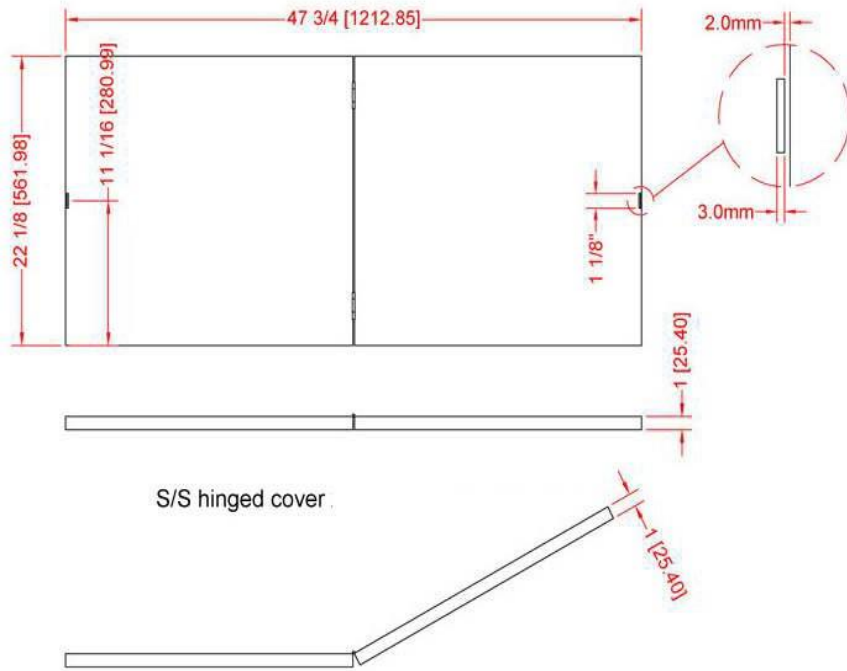

S/S hinged cover .